

winter shadow studies

Option 01

The proposed tower locations and heights have been designed so that there is no impact on the surrounding outdoor public areas, in particular the outdoor public space located to the south of Close Street and to the north of the Cooks River - the Close Street Reserve.

All building elements including lift overruns, and essential services and communications have been designed to be under the sun access plane.



21st June 9.00am



21st June 10.00am

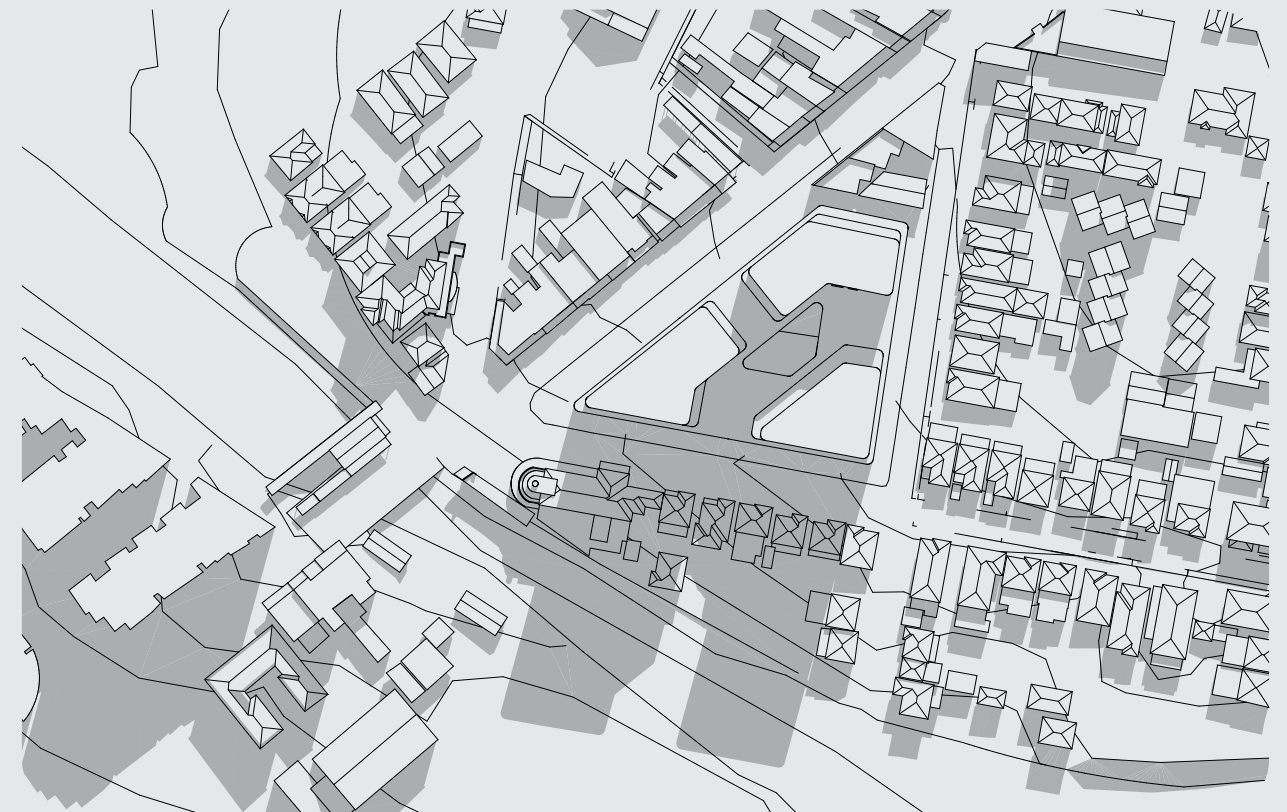

21st June 11.00am

winter shadow studies

Option 01



21st June 12.00pm

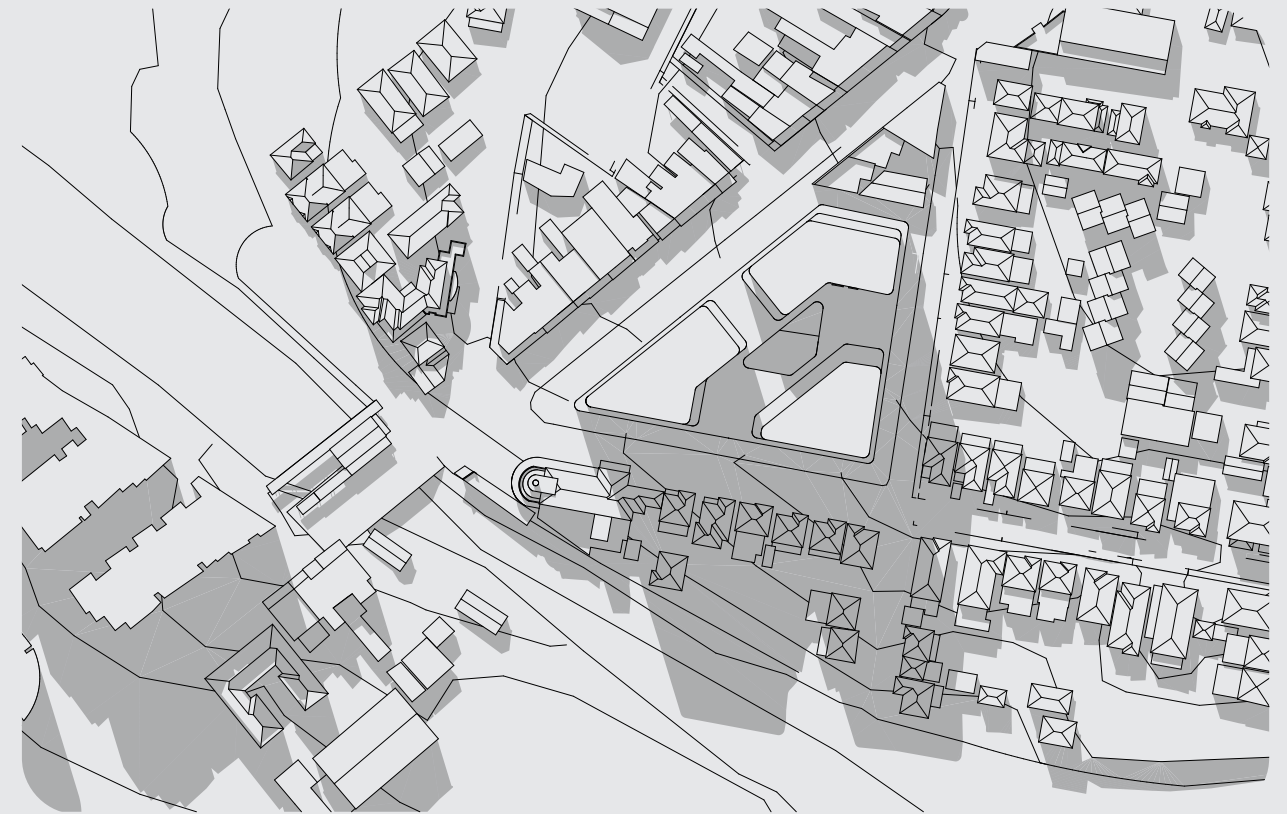

21st June 1.00pm



21st June 2.00pm



21st June 3.00pm